

**Mid – America Working Terrier Trials**  
**Sanctioned Trial by the Jack Russell Terrier Club of America**  
Exhibitors and Owners of Jack Russell Terriers Entered must be current JRTCA Members

**MID-AMERICA**

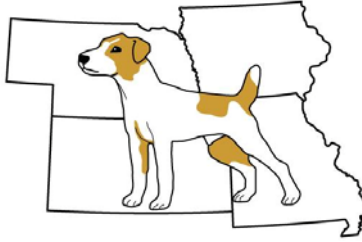

**WORKING TERRIER  
ASSOCIATION**

**June 23 & 24, 2018**  
**Ta-Ha Zouka Park**  
**Norfolk, NE**

**Sponsored By:**  
MAWTA BOD  
MAWTA Members  
A grant produced by  
Norfolk Area Sports Council  
Cornhusker Auto

**Judges:**

**Conformation**

Shirley Buist & Stephen Darroch

**Go to Ground**

Ted Ely & Stephen Martin

**Racing**

Bryan Schramer & Candy Butterfield

**Barn Hunt**

David Krietemeyer & Brian Smith

**Trial Secretary:**

Melissa Baggenstoss  
201 5<sup>th</sup> St  
North Grove City, MN 56243  
320-310-1111  
Email: [baggendjackrussellterriers@gmail.com](mailto:baggendjackrussellterriers@gmail.com)

**Trial Administrator** CO

Patti Podliska  
83610 US Hwy 81  
Norfolk, NE 68701  
[mawta@live.com](mailto:mawta@live.com)

**Trial Administrator**

Joy Krietemeyer  
15944 54<sup>th</sup> St.  
Oskaloosa, Kansas 66066  
[joylkriet@aol.com](mailto:joylkriet@aol.com)

# JRTCA Rules for Exhibitors

1. All sanctioned classes are open to Jack Russell Terriers only
2. Exhibitors and owners of terriers entered must be current JRTCA members, and must not be a member of a conflicting JRT organization or register their JRTs in any all-breed registry or conflicting JRT organization registry. If an exhibitor is found to be in violation of this policy, entry will be disqualified and no refunds given. If a violation is confirmed after the trial, placements will be voided from all JRTCA records. Exhibitors must submit a completed entry form including a signed waiver for every trial they enter.
3. Entries MUST be within the 10-15" JRTCA height standard for all sanctioned classes (with the exception of pups who have not yet met the 10" height standard); measuring devices will be available on the trial grounds.
4. Puppies (under 12 months of age) are not eligible for championship in any division but their own. Puppies are eligible to compete only if they have reached their four-month birthday (not
5. Bitches in season may not compete in any division. Pre-entry fees of bitches in season to be refunded with vet certificate from owner, or as otherwise agreed upon by the Trial Chairman.
6. Spayed or neutered terriers may compete in Miscellaneous Conformation. They may not compete in Puppy, Family\*, Open or Working Conformation.  
\*Note: For Family Classes, Brood Bitches and Stud Dogs entered may not be spayed/neutered. The offspring at their sides may be intact or spayed/neutered.
7. A terrier bred by a Sanctioned JRTCA Judge may not be shown under that Judge in the Conformation division.
8. Terriers owned or co-owned by the Trial Chairperson, or any member of their household, may not be entered in any phase of the competition, with the exception of Child and Youth Handling.
9. Terriers owned by judges may not be entered in the division in which they are judging, but may enter the competition in any other division.
10. Terriers owned by stewards may be entered in any division provided that they find a substitute to perform their duties or have someone else show their terriers.
11. Requests for the measurement of a terrier entered in any class number may be made only by another exhibitor in that same class number or by the Judge EXCEPT in Racing. Requests for the measurement of a terrier in Racing may be made by the Judge or by an exhibitor with a terrier entered in the same class number; OR, if classes are split by gender, may call for the measurement of a terrier of the opposite gender in the same age and height category. (Example: The owner of an under adult dog entered in Racing may call for the measurement of an under adult bitch as the potential exists for them to race each other in the Championship Races.) Exhibitors racing puppies may call for the measurement of a puppy in a different age category as long as it is in the same height category. The person making the request for measurement must name the terrier or terriers they wish to have measured, but requests for measurement of entire classes will not be honored. The measurement of the terrier will be considered the terrier's official height for the duration of the trial. Only JRTCA height cards issued after September, 1999 will be honored.
12. Excessive use of squeaky or fur-like baiting devices by exhibitors is prohibited in the Conformation ring and may result in the exhibitor being excused from the class. "Excessive Use" will be at the judge's discretion.
13. Exhibitors participating in the JRTCA Working Terrier classes or Certificate Go-to-Ground must submit the appropriate JRTCA certificates with pre-entries or at the time of post-entry. The Judge may require a copy of the certificate be presented to the ring/den steward at the time of judging. Registered terriers may submit a copy of a NHC application signed by a JRTCA Working Judge within 30 days of the date it was issued.
14. Puppies under the age of three months are not permitted on the trial grounds. Any person violating this rule will be excused from all classes entered, and asked to leave the trial site.
15. All dogs must be leashed or crated except when competition requires off leash work. No liberty leashes allowed.
16. Overly aggressive dogs or an owner's failure to control his/her dog may result in disqualification at the discretion of the judges or the Trial Chairperson.
17. The abuse or severe disciplining of dogs on the trial grounds is prohibited. Anyone displaying such behavior will be asked to leave the trial site, and no entry fees will be refunded.
18. Dogs, other than JRTs, on the grounds may be excluded or permitted at the discretion of the Trial Chairperson.
19. Exhibitors are responsible to double-check the classes they have entered and be on time. No refunds will be given for missed classes.
20. The owner/handler of a terrier entering any class does so at his/her own risk and agrees to abide by the rules of the JRTCA and the trial. A copy of the JRTCA Rule Book can be obtained by contacting the JRTCA office (410-561-3655), or it can be downloaded from the JRTCA web site ([www.terrier.com](http://www.terrier.com)).
21. Unsportsmanlike conduct, or the use of foul and abusive language, will not be tolerated. Anyone demonstrating such conduct will be asked to leave the trial site and no entry fees will be refunded. In addition, such conduct will be subject to penalties, which may include the suspension of membership, restriction from entering the JRTCA National Trial, and/or fines. Trial Chairpersons have the right to refuse any entry at their sole and absolute discretion.
22. All dogs brought to JRTCA sanctioned trials must be current on vaccinations. No dogs of any age may be brought to a trial who have suspicion of contagious or infectious disease.
23. THE JUDGE'S DECISIONS CONCERNING PLACEMENTS ARE FINAL IN ALL DIVISIONS!

# Mid-America Working Terrier Trial Schedule

This schedule is an **approximation only** and is subject to change at the discretion of the trial chairperson and trial administrators.

Saturday, June 23, 2018

Races .....	08:00 AM
(Meeting will take place at 8:00 AM; racing will start right after the meeting)	
Go-to-ground .....	09:00 AM
Super earth .....	09:00 AM
Youth .....	10:00 AM
Barn Hunt .....	10:00 AM
Conformation .....	10:15 AM
Lure Course .....	12:00 PM

Sunday, June 24, 2018

Races .....	08:00 AM
(Meeting will take place at 8:00 AM; racing will start right after the meeting)	
Go-to-ground .....	09:00 AM
Super earth .....	09:00 AM
Youth .....	10:00 AM
Barn Hunt .....	10:00 AM
Conformation .....	10:15 AM

### Please remember

Your JRTCA registration /recording number is required as of Jan 1st, 2010 on your entry form.  
If your terrier is not registered or recorded there will be an additional \$5.00 JRTCA fee per day per dog.  
Total of \$7.00 per dog/per day for administration fees if the JRT is not registered with the JRTCA.  
This does not apply to puppies under 12 months old. Non-Sanctioned classes do not have a per dog fee.

Thank you for your cooperation in this matter.  
If you have any questions please email or call any one of us.

### Important Notices for Exhibitors

Pre – Entry \$12.00 per class / Post –Entry \$15.00 Pre-Entry Deadline June 8, 2018 (mailed) Trial Vault June 15, 2018  
you can pay pre-entry by paypal: [mawta@live.com](mailto:mawta@live.com) or Stripe right on the Trail Vault.  
We will not pay the Transaction fees, that is your responsibility.

- Every effort will be made to start trial events on time. **Dogs late to racing or conformation will be scratched. NO REFUNDS for missed classes.**
- REFUNDS for classes will be given ONLY in cases of accident or illness of a terrier or owner, or for bitches in season. Situations must be documented in writing. Refunds provided by mail within 14 days following the trial.
- **ENTRIES must be postmarked by June 8, 2018. Trial Vault June 15, 2018** Entries postmarked after that date will be considered post entries and charged accordingly. Please pre-enter for the trial, this helps the trial run smoother and is cheaper for you. No phone entries, please.
- CLASSES may be combined if insufficient entries are received.
- CROSS ENTERING is not permitted within the Open Section of the Conformation Division. Also, terriers may not enter both the Open and Working sections.
- RIBBONS 1<sup>st</sup> to 6<sup>th</sup>
- **RAFFLE – Please support the raffle by donating at least one raffle prize.**
- VENDORS – No fee is required; however, vendors are required to furnish a nice raffle prize. Please support the vendors.
- **No Alcoholic Beverages allowed in the Park**
- **Clean up after your dogs Where Ever you GO!**
- No Post Entries for the JRTCA racing
- Colored Terrier owners DO NOT have to be members of the JRTCA to compete.
- All payments must be in US currency, US Banks.

# Saturday & Sunday

---

## Races

---

ALL terriers must be muzzled to race with either a plastic basket or close-ended cloth muzzle, NO colored muzzles. No cross entering. To be eligible in the Championship, terriers must compete in both flats & hurdles. You MUST have your Jack ON DECK and securely muzzled in order to race. If you need help, please ask for it in advance. DO NOT wait until it's time to load into the starting boxes. BE PREPARED. Racing classes will be run in the precise sequence posted in this trial premium.

### Flat Puppy Races

**Class 1:** Pups, 4 up to 6 months, Non-sanctioned.

**Class 2:** Pups, 6 up to 9 months, up to 12.5".

**Class 3:** Pups, 6 up to 9 months, over 12.5" up to 15".

**Class 4:** Pups, 9 up to 12 months, up to 12.5".

**Class 5:** Pups, 9 up to 12 months, over 12.5" up to 15".

### Flat Senior Races

**Class 6:** Senior dogs, 9 years and older, 10 up to 12.5"

**Class 7:** Senior dogs, 9 years and older, over 12.5" up to 15".

**Class 8:** Senior bitches, 9 years and older, 10 up to 12.5"

**Class 9:** Senior bitches, 9 years and older, over 12.5" up to 15"

### Flat Adult Races

**Class 10:** Dogs, 1 year and older, 10 up to 12.5".

10:

**Class 11:** Dogs, 1 year and older, over 12.5" up to 15".

11:

**Class 12:** Bitches, 1 year and older, 10 up to 12.5".

12:

**Class 13:** Bitches, 1 year and older, over 12.5" up to 15".

13:

### Flat Veteran Races

**Class 14:** Veteran dogs, 6 years and older, 10 up to 12.5"

14:

**Class 15:** Veteran dogs, 6 years and older, over 12.5" up to 15".

15:

**Class 16:** Veteran bitches, 6 years and older, 10 up to 12.5"

16:

**Class 17:** Veteran bitches, 6 years and older, over 12.5" up to 15".

17:

### Flat Other Terrier Races

**Class 18:** Other Terrier, 1 year and older, Under 12.5" (Non-Sanctioned)

18: Open to all breeds. Dog and bitches over 1 year of age.

**Class 19:** Other Terrier, 1 year and older, Over 12.5" (Non-Sanctioned)

19: Open to all breeds. Dog and bitches over 1 year of age.

## Steeplechase Puppy Races

**Class** Pups, 6 up to 9 months, up to 12.5"

**20:**

**Class** Pups, 6 up to 9 months, over 12.5" up to 15"

**21:**

**Class** Pups, 9 up to 12 months, up to 12.5"

**22:**

**Class** Pups, 9 up to 12 months, over 12.5" up to 15"

**23:**

## Steeplechase Senior Races

**Class** Senior dogs, 9 years and older, 10 up to 12.5"

**24:**

**Class** Senior dogs, 9 years and older, over 12.5" up to 15"

**25:**

**Class** Senior bitches, 9 years and older, 10 up to 12.5".

**26:**

**Class** Senior bitches, 9 years and older, over 12.5" up to 15"

**27:**

## Puppy Racing Finals

**Class** 4-6 MONTH PUPPY RACING BEST & RESERVE

**28:** Non-Sanctioned.

**Class** PUPPY RACING CHAMPION & RESERVE UP TO 12.5".

**29:** Open to 1st place winners of up to 12.5" puppy classes 2, 4, 20, 22 . No entry fee.

**Class** PUPPY RACING CHAMPION & RESERVE OVER 12.5" UP TO 15".

**30:** Open to 1st place winners of 12.5 up to 15" puppy classes 3, 5, 21, 23. No entry fee.

## Senior Racing Finals

**Class** SENIOR RACING CHAMPION & RESERVE 10 UP TO 12.5".

**31:** Open to 1st place winners of 10 up to 12.5" senior classes 6, 8, 24, 26. No entry fee.

**Class** SENIOR RACING CHAMPION & RESERVE OVER 12.5" UP TO 15".

**32:** Open to 1st place winners of 12.5 up to 15" senior classes 7, 9, 25, 27. No entry fee.

## Steeplechase Adult Races

**Class** Dogs, 1 year and older, 10 up to 12.5".

**33:**

**Class** Dogs, 1 year and older, over 12.5" up to 15".

**34:**

**Class** Bitches, 1 year and older, 10 up to 12.5".

**35:**

**Class** Bitches, 1 year and older, over 12.5" up to 15".

**36:**

## Steeplechase Veteran Races

**Class** Veteran dogs, 6 years and older, 10 up to 12.5".

**37:**

**Class** Veteran dogs, 6 years and older, over 12.5" up to 15".

**38:**

**Class** Veteran bitches, 6 years and older, 10 up to 12.5".

**39:**

**Class** Veteran bitches, 6 years and older, over 12.5" up to 15".

**40:**

### **Adult Racing Finals**

**Class** ADULT RACING CHAMPION & RESERVE 10 UP TO 12.5".

**41:** Open to 1st place winners of 10 up to 12.5" adult classes 10, 12, 33, 35.  
No entry fee.

**Class** ADULT RACING CHAMPION & RESERVE OVER 12.5" UP TO 15".

**42:** Open to 1st place winners of 12.5 up to 15" adult classes 11, 13, 34, 36.  
No entry fee.

### **Veteran Racing Finals**

**Class** VETERANS RACING CHAMPION & RESERVE 10 UP TO 12.5".

**43:** Open to 1st place winners of 10 up to 12.5" veteran classes 14, 16, 37, 39. No entry fee.

**Class** VETERANS RACING CHAMPION & RESERVE OVER 12.5" UP TO 15".

**44:** Open to 1st place winners of 12.5 up to 15" veteran classes 15, 17, 38, 40. No entry fee.

### **Steeplechase Other-Terrier Races**

**Class** Other Terrier Under 12.5" (Non-Sanctioned)

**45:** Open to all breeds. Dog and bitches over 1 year of age.

**Class** Other Terrier Over 12.5" (Non-Sanctioned)

**46:** Open to all breeds. Dog and bitches over 1 year of age.

### **Other-Terrier Racing Finals (NON-Sanctioned)**

**Class** OTHER RACING BEST & RESERVE 10 UP TO 12.5" Open to 1<sup>st</sup> place winners in 10 up to 12.5" Other Terrier Racing classes 18, 45  
**47:** Open to all breeds Dog and Bithes over 1 year of age No entry fee

**Class** Other Racing Best & Reserve Over 12.5" Open to 1<sup>st</sup> Place winners in Over 12.5" Other Terrier Racing Classes 19, 46. Open to all breeds dogs & bitches over 1 year of age No Entry Fee  
**48:**

---

## Youth

---

**Child Handler, Youth Handler, and Youth Go-To-Ground are mandatory classes for every trial and must be the first conformation classes of the day. The Youth Division is listed as an entirely separate division. Please note that these classes are not included in any other division of the Trial. Youth / Child handlers must compete with the same terrier in each class. Youth handlers must compete with a terrier that is at least 1 year of age. A child/youth exhibitor's age is determined as of January 1st of the current calendar year.**

**Class Child handler**

**49:** Open to any youth aged 5 through 9, handling a Jack Russell Terrier, six months of age or older. This class is offered as an introductory experience in handling and learning about the Jack Russell Terrier. Judged on child's ability to present his/her dog and beginning knowledge of the Jack Russell. Quality of the dog NOT to be considered

**Class Child Go-to-Ground**

**50:** Open to any child aged 5 through 9, handling an adult Jack Russell Terrier. Judged on the child's ability to present his/her dog and knowledge of Go-To-Ground. To be run through the 10-foot Novice tunnel; time not to be considered. If the terrier is competing in a regular GTG class, it needs to run in the regular GTG class before it can compete in Child Go-To-Ground. (Non-Sanctioned).

**Class CHILD HANDLER HIGH SCORE & RESERVE**

**51:** Awarded to the highest scoring Child Handler and runner-up in classes. The points are awarded as follows: 1st = 8 points; 2nd = 6 points; 3rd = 5 points; 4th = 4 points; 5th place = 3 points, 6th place = 2 points, and participation = 1 point. (Non-Sanctioned, No entry fee).

**Class Youth handler**

**52:** Open to any youth aged 10 through 16, handling an adult Jack Russell Terrier. Judged on the youth's ability to present his/her dog and knowledge of the Jack Russell Terrier. Quality of the dog NOT to be considered.

**Class Youth Working Judge**

**53:** Open to any youth handler aged 10 through 16 handling an adult JRT. Judged on the youths knowledge of hunting and the working terrier, and ability to answer questions presented by a JRTCA Working Judge; no terrier to accompany handler in class.

**Class Youth Handler Go-to-Ground**

**54:** Open to any youth aged 10 through 16, handling an adult Jack Russell Terrier. Judges on Youth's ability to present his/her dog and knowledge of GTG. To be run through 10 foot novice liner. Time not to be considered. If terrier is competing in a regular GTG class, it needs to run in regular GTG class before it can compete in Youth GTG.

**Class YOUTH HANDLER HIGH SCORE & RESERVE**

**55:** Awarded to highest scoring youth and runner up in class 52, 53, and 54. The points are awarded as follows: 1st = 8 points, 2nd = 6, 3rd = 4, etc; 5th place = 3 points, 6th place = 2 points, and participation = 1 point Youth exhibitors must complete a minimum of youth conformation and GTG to qualify for the youth handler high score and reserve. In the case of a tie, it will be broken by a handling class to be held in the conformation ring, judge to be decided by trial chairperson.

---

## Conformation

---

All terriers are judged on the JRTCA breed standard, except Child/Youth handlers where conformation is not considered and judging is based on the handler's ability. All terriers must be exhibited on lead. Cross-entering is not permitted between the Open Section and the Working Section. JRTCA Working Conformation is open to any JRTCA-registered terrier owned by a JRTCA member which holds a JRTCA Natural Hunting Certificate (NHC). A copy of the NHC certificate must be submitted with pre-entry or presented in the ring at time of judging.

### Working Terrier Conformation

- Class** **Bronze medallion dog**  
**56:** Open to any terrier, which has earned the JRTCA Bronze Medallion for Special Merit in the Field.
- Class** **Working terrier dog, 10 up to 12.5", smooth**  
**57:**
- Class** **Working terrier dog, 10 up to 12.5", rough/broken**  
**58:**
- Class** **Working terrier dog, over 12.5 up to 15", smooth**  
**59:**
- Class** **Working terrier dog, over 12.5 up to 15", rough/broken**  
**60:**
- Class** **BEST WORKING TERRIER DOG & RESERVE**  
**61:** Open to 1st and 2nd place winners of classes 56 through 60 No entry fee.
- Class** **Bronze medallion bitch**  
**62:** Open to any bitch, which has earned the JRTCA Bronze Medallion for Special Merit in the field.
- Class** **Working terrier bitch, 10 up to 12.5", smooth**  
**63:**
- Class** **Working terrier bitch, 10 up to 12.5", rough/broken**  
**64:**
- Class** **Working terrier bitch, over 12.5 up to 15", smooth**  
**65:**
- Class** **Working terrier bitch, over 12.5 up to 15", rough/broken**  
**66:**
- Class** **BEST WORKING TERRIER BITCH & RESERVE**  
**67:** Open to 1st and 2nd place winners of classes 62 through 66.
- Class** **WORKING TERRIER CHAMPION & RESERVE**  
**68:** Open to 1st and 2nd place winners from classes Best Working Dog class 61 and Best Working Bitch class 67. No entry fee.

### Miscellaneous

- Class** **Neutered adult dog**  
**69:** Open to any male Jack Russell Terrier at least one year old. Judged on the Breed Standard and condition of the terrier.
- Class** **Spayed adult bitch**  
**70:** Open to any female Jack Russell Terrier at least one year old. Judged on the Breed Standard and condition of the terrier
- Class** **Spayed/Neutered Working Terrier**  
**71:** Open to any adult Spayed/Neutered Jack Russell Terrier, which holds a JRTCA Natural Hunting Certificate. NHC to be provided with entry form or at time of class.



- Class 72: Veteran Dog**  
Open to any male Jack Russell aged 6 years and over. Judged on breed standard and condition of the dog.
- Class 73: Veteran Bitch**  
Open to any female Jack Russell aged 6 years or older. Judged on breed standard and condition of the dog.
- Class 74: BEST VETERAN TERRIER & RESERVE**  
Open to the first and second place winners of veteran terrier classes. 72 & 35 Non-Sanctioned, No Entry fee.
- Class 75: Other Terrier Puppies, 4-12 months Non-Sanctioned**
- Class 76: Other Terrier Dog**  
Open to any earth-working breeds. Non-sanctioned.
- Class 77: Other Terrier Bitch**  
Open to any earth-working breeds. Non-sanctioned.
- Class 78: BEST OTHER TERRIER & RESERVE**  
Open to the first and second place winners of other terrier classes. 75 through 77 Non-sanctioned, No entry fee.

### Suitability

Open to any adult JRT, including those which have been spayed or neutered. The dog the Judge would choose to take hunting to each quarry listed below.

- Class 79: Suitability to red fox**
- Class 80: Suitability to groundhog**
- Class 81: Suitability to raccoon/badger**
- Class 82: Tool Box Open** to handler with three adult Terrier types at side; one suitable to each quarry (Fox, groundhog, raccoon/badger) Placement based on the group the judge would choose to take hunting. **NON-Sanctioned, This class if open to ALL TERRIER TYPES(Patterdale, Judge, Border, Norwich, Norfolk ext.....)**

### Breeder's Classes

- Class 83: Stud dog and get**  
Open to a sire with at least two, but not more than three offspring at parent's side. Judge on Breed Standard and consistency of type. Stud Dog must be an intact male. Offspring may be intact or spayed/neutered.
- Class 84: Brood bitch and produce**  
Open to dam with at least two, but not more than three offspring at parent's side. Judged on Breed Standard and consistency of type. Brood Bitch must be intact. Offspring may be intact or spayed/neutered.
- Class 85: BEST FAMILY & RESERVE**  
Open to 1st and 2nd place winners of Stud Dog and Get, Brood Bitch and Produce, No entry fee.
- Class 86: Three-Generations.** Open to a minimum of three successive generations of breeding; the second and successive generations must be bred by the exhibitor.

## **4-6 Month Puppy Conformation**

**Class** Puppies, 3 up to 4 months (non-sanctioned)

**87:**

**Class** Dog Pups, 4 up to 6 months, smooth

**88:**

**Class** Dog Pups, 4 up to 6 months, rough/broken

**89:**

**Class** Best/Reserve Best 4 up to 6 month Dog Puppy

**90:** Open to 1st and 2nd place winners of classes 88 through 89. No entry fee.

**Class** Bitch Pups, 4 up to 6 months, smooth

**91:**

**Class** Bitch Pups, 4 up to 6 months, rough/broken

**92:**

**Class** Best/Reserve Best 4 up to 6 month Bitch Puppy

**93:** Open to 1st and 2nd place winners of classes 91 through 92. No entry fee.

**Class** BEST 4-6 MONTH PUPPY & RESERVE

**94:** Open to 1st and 2nd place winners of classes 90 through 93. No entry fee.

## **6-12 Month Puppy Conformation**

**Class** Dog pups, 6-9 months, smooth

**95:**

**Class** Dog pups, 6-9 months, r/br

**96:**

**Class** Dog pups, 9-12 months, smooth

**97:**

**Class** Dog pups, 9-12 months, r/br

**98:**

**Class** BEST 6-12 PUPPY DOG & RESERVE

**99:** Open to 1st and 2nd place winners of classes 95 through 98. No entry fee.

**Class** Bitch pups, 6-9 months, smooth

**100:**

**Class** Bitch pups, 6-9 months, r/br

**101:**

**Class** Bitch pups, 9-12 months, smooth

**102:**

**Class** Bitch pups, 9-12 months, r/br

**103:**

**Class** BEST 6-12 MONTH PUPPY BITCH & RESERVE

**104:** Open to 1st and 2nd place winners of classes 100 through 103. No entry fee.

**Class** PUPPY CONFORMATION CHAMPION & RESERVE

**105:** Open to winners of classes 99 and 104. No entry fee.

## **Open Adult Conformation**

**Class Bred by exhibitor dog**

**106:** Open to any adult Jack Russell Terrier owned and bred by the exhibitor; must be handled by the breeder under whose kennel prefix the terrier is registered or a member of the breeder's immediate family.

**Class Dogs, 1 year and older, 10 up to 12.5", smooth**

**107:**

**Class Dogs, 1 year and older, 10 up to 12.5", rough/broken**

**109:**

**Class Dogs, 1 year and older, over 12.5 up to 15", smooth**

**110:**

**Class Dogs, 1 year and older, over 12.5 up to 15", rough/broken**

**111:**

**Class BEST OPEN DOG & RESERVE**

**112:** Open to 1st and 2nd place winners of classes 106 through 111. No entry fee.

**Class Bred by exhibitor bitch**

**113:** Open to any adult Jack Russell Terrier owned and bred by the exhibitor; must be handled by the breeder under whose kennel prefix the terrier is registered or a member of the breeder's immediate family

**Class Bitches, 1 year and older, 10 up to 12.5", smooth**

**114:**

**Class Bitches, 1 year and older, 10 up to 12.5", rough/broken**

**115:**

**Class Bitches, 1 year and older, over 12.5 up to 15", smooth**

**116:**

**Class Bitches, 1 year and older, over 12.5 up to 15", rough/broken**

**117:**

**Class BEST OPEN BITCH & RESERVE**

**118:** Open to Best and Reserve from classes 113 through 117. No entry fee.

**Class BEST OPEN TERRIER & RESERVE**

**119:** Open to Best & Reserve from classes 112 and 118. No entry fee.

---

## Go-to-ground

---

A timed event that simulates the terrier's natural instinct to hunt. The terrier enters an artificial den/tunnel to demonstrate its working ability. Schooling prior to the competition is not permitted. Any violation of this rule shall result in disqualification from the Go-To-Ground competition at this trial. For all classes: work is defined as baying, digging, concentrated stare, whining or biting at the bars. A break in work is defined as ceasing to work for a period of more than ten seconds. Leaving the quarry is defined as moving back in the tunnel away from quarry and out of the view of the judge. The judge may halt the work, if the judge believes the terrier is injuring itself. Copies of JRTCA trial certificate must be submitted with pre-entries or presented to the den steward at the time of judging. Cross entering is not permitted between certificate classes.

**Class Pre-novice puppy**

**120:** Open to Jack Russell puppies 4 up to 6 months. Entry in Pre-Novice Puppy class does not affect the puppy's eligibility to enter the Novice Class after 6 months of age. (One minute to reach quarry; may leave earth and re-enter until quarry is reached; mark quarry for 15 seconds without a break in work and without leaving quarry. May switch from one type of work to another. Example: baying to concentrated stare or digging to baying)

**Class Novice puppy**

**122:** Open to Jack Russells 6 up to 12 months that have not scored 100% in this class at a previous JRTCA trial. Entries earning a score of 100% at this trial may, upon payment of the entry fee, enter the Open Puppy Class at this trial. (One minute to reach quarry; may leave earth and re-enter several times until quarry is reached; when quarry is reached must work quarry continuously for a full 30 seconds without a break in work and without leaving the quarry; may switch from one type of work to another (examples. baying to concentrated stare or digging to baying.)

**Class Novice adult**

**123:** Open to Jack Russells one year of age or older which have not scored 100% in this class at a previous JRTCA trial. Entries earning a score of 100% at this trial may upon payment of the entry fee, enter the Open class at this trial. (One minute to reach quarry; may leave earth and re-enter several times until quarry is reached; must work quarry continuously for a full 30 seconds without a break in work and without leaving the quarry; may switch from one type of work to another (examples baying to concentrated stare or digging to baying.)

**Class Open puppy**

**124:** Open to Jack Russells 6 up to 12 months which have scored 100% in a Novice Go-To-Ground class at this or a previous JRTCA trial. Not open to any puppies which have previously achieved 100% in this class. Puppies earning a score of 100% at this trial may, upon payment of the entry fee, enter the Puppy Championship GTG class at this trial. (30 seconds to reach quarry; may leave earth once and re-enter before quarry is reached; must work quarry continuously for one full minute without a break in work and without leaving quarry. May switch from one type of work to another. Example: baying to concentrated stare or digging to baying)

**Class Open adult**

**125:** Open to Jack Russells one year or older which have scored 100% in a Novice Go-To-Ground class at this or a previous JRTCA trial. (30 seconds to reach quarry; may leave earth once and re-enter before the quarry is reached; must work quarry continuously for one full minute without a break in work and without leaving quarry; may switch from one type of work to another.)

**Class Puppy championship**

**126:** Open to Jack Russells, 6 up to 12 months which have earned 100% in an Open Go-To-Ground class at this or a previous JRTCA trial. A copy of a 100% Open score sheet shall be submitted with pre-entry or be shown to the Den Steward at the time of the class. First and second place winners will be Puppy Go-To-Ground Champion and Reserve. (30 seconds to reach quarry; may leave earth once and re-enter before the quarry is reached; when quarry is reached must work quarry for one full minute without a break in work and without leaving quarry. May switch from one type of work to another. Example: baying to concentrated stare or digging to baying.)

**Class Adult 10 up to 12.5" championship certificate**

**127:** Open to any adult Jack Russell 10" up to 12.5", one year and over, which holds a JRTCA Trial Certificate. A copy of the certificate must be submitted with pre-entry or be shown to the Den Steward at the time of the class. First and second place winners will be Go-To-Ground Champion and Reserve. (30 seconds to reach quarry; may not leave earth; work quarry for one full minute without a break in work and without leaving quarry. May switch from one type of work to another.)

**Class Adult over 12.5" up to 15" championship certificate**

**128:** Open to any adult Jack Russell over 12.5" up to 15", one year and over, which holds a JRTCA Trial Certificate. A copy of the certificate must be submitted with pre-entry or be shown to the Den Steward at the time of the class. First and second place winners will be Go-To-Ground Champion and Reserve. (30 seconds to reach quarry; may not leave earth; work quarry for one full minute without a break in work and without leaving quarry. May switch from one type of work to another.)

**Class Veteran 10 up to 12.5" championship certificate**

**129:** Open to any adult Jack Russell 10" up to 12.5" 6 years of age or older, who holds a JRTCA Trial Certificate. A copy of certificate must be submitted with pre-entry or be shown to Den Steward at time of the class. CROSS-ENTERING IS NOT PERMITTED BETWEEN CERTIFICATE CLASSES. (30 seconds to reach quarry; may not leave earth; work quarry for one full minute without a break in work and without leaving quarry. May switch from one type of work to another.)

**Class Veteran over 12.5" up to 15" championship certificate**

**130:** Open to any adult Jack Russell over 12.5" up to 15" 6 years of age or older, who holds a JRTCA Trial Certificate. A copy of certificate must be submitted with pre-entry or be shown to Den Steward at time of the class. CROSS-ENTERING IS NOT PERMITTED BETWEEN CERTIFICATE CLASSES. (30 seconds to reach quarry; may not leave earth; work quarry for one full minute without a break in work and without leaving quarry. May switch from one type of work to another.)

**Class Senior 10 up to 12.5" championship certificate**

**131:** Open to any adult Jack Russell 10" up to 12.5" 9 years of age or older, who holds a JRTCA Trial Certificate. A copy of certificate must be submitted with pre-entry or be shown to Den Steward at time of the class. CROSS-ENTERING IS NOT PERMITTED BETWEEN CERTIFICATE CLASSES. (30 seconds to reach quarry; may not leave earth; work quarry for one full minute without a break in work and without leaving quarry.)

**Class Senior over 12.5" up to 15" championship certificate**

**132:** Open to any adult Jack Russell over 12.5" up to 15" 9 years of age or older, who holds a JRTCA Trial Certificate. A copy of certificate must be submitted with pre-entry or be shown to Den Steward at time of the class. CROSS-ENTERING IS NOT PERMITTED BETWEEN CERTIFICATE CLASSES. (30 seconds to reach quarry; may not leave earth; work quarry for one full minute without a break in work and without leaving quarry.)

## **Non-sanctioned Go-to-Ground**

**Class** Other Terrier Novice Puppy

**133:**

**Class** Other Terrier Open Puppy

**134:**

**Class** Other Terrier Novice Adult

**135:**

**Class** Other Terrier Open Adult

**136:**

---

## **Super earth**

---

30 seconds per 30 feet of tunnel to reach quarry; may leave and re-enter earth; work quarry for one full minute without a break in work and without leaving quarry. May switch from one type of work to another without penalty. Classes may be combined as entries warrant. Sanctioned classes; check rules posted. Cross entering is not permitted between certificate classes.

**Class** 6 up to 12 month puppy super earth

**137:**

**Class** Adult 10 up to 12.5" super earth

**138:** Open to terriers one year and older

**Class** Adult over 12.5" up to 15" super earth

**139:** Open to terriers one year and older

**Class** Veteran Super Earth, 10 up to 12.5"

**140:** Open to terriers six years and older.

**Class** Veteran Super Earth, over 12.5" up to 15"

**141:** Open to terriers six years and older.

**Class** Senior Super Earth, 10 up to 12.5"

**142:** Open to terriers 9 years and older..

**Class** Senior Super Earth, over 12.5 up to 15"

**143:** Open to terrier 9 years and older.

**Class** Adult 10 up to 12.5" certificate super earth

**144:** Open to Jack Russell Terriers, one year and older, which hold a JRTCA Super Earth Trial Certificate. A copy of the certificate must be submitted with pre-entry or be shown to the Den Steward at the time of the class. First and Second Place winners will be Under Adult Super Earth Champion and Reserve.

**Class** Adult over 12.5 up to 15" certificate super earth

**145:** Open to Jack Russell Terriers, one year and older, which hold a JRTCA Super Earth Trial Certificate. A copy of the certificate must be submitted with pre-entry or be shown to the Den Steward at the time of the class. First and Second Place winners will be Over Adult Super Earth Champion and Reserve.

**Class** Veteran 10 up to 12.5" certificate super earth

**146:** Open to Jack Russell Terriers, six years and older, which hold a JRTCA Super Earth Trial Certificate. A copy of the certificate must be submitted with pre-entry or be shown to the Den Steward at the time of the class. First and Second Place winners will be Under Veteran Super Earth Champion and Reserve.

**Class** Veteran over 12.5 up to 15" certificate super earth

**147:** Open to Jack Russell Terriers, six years and older, which hold a JRTCA Super Earth Trial Certificate. A copy of the certificate must be submitted with pre-entry or be shown to the Den Steward at the time of the class. First and Second Place winners will be Over Veteran Super Earth Champion and Reserve.

**Class Senior 10 up to 12.5" certificate super earth**

**148:** Open to Jack Russell Terriers, nine years and older, which hold a JRTCA Super Earth Trial Certificate. A copy of the certificate must be submitted with pre-entry or be shown to the Den Steward at the time of the class. First and Second Place winners will be Under Senior Super Earth Champion and Reserve.

**Class Senior over 12.5 up to 15" certificate super earth**

**149:** Open to Jack Russell Terriers, nine years and older, which hold a JRTCA Super Earth Trial Certificate. A copy of the certificate must be submitted with pre-entry or be shown to the Den Steward at the time of the class. First and Second Place winners will be Over Senior Super Earth Champion and Reserve

### **Non-sanctioned Super Earth**

**Class Other Terrier Under 12.5"**

**150:** Open to all breeds. Dogs and bitches over 1 year of age.

**Class Other Terrier Over 12.5"**

**151:** Open to all breeds. Dogs and bitches over 1 year of age.

**Class Other Terrier Puppies, 6-12 months**

**152:**

---

## **Barn Hunt**

---

4 tubes will be placed within a hay bales with only one containing the quarry. With your help, the terrier must locate and work the rat within this simulated barn environment. Time starts when terrier is released. (Non-Sanctioned Division)

**Class Puppies, 4-12 months**

**153:**

**Class Adults**

**154:**

**Class BARN HUNT BEST & RESERVE**

**155:**

---

## **Lure Coursing Saturday ONLY**

---

**Class Puppies, 6 up to 12 months**

**156:** Timed event with the terrier chasing the lure. Fastest time of the two runs qualifies for the ribbons

**Class Adults, 1 year & older**

**157:** Times event with the terrier chasing the lure. Fastest time of two runs qualifies for the ribbons

**Class Veterans**

**158:** Times event with the terrier chasing the lure. Fastest time of two runs qualifies for the ribbons

**Class LURE COURSING BEST AND RESERVE**

**159:** Best and reserve scores from classes 156, 157 158. No Entry Fee.

## Sponsors:

Produced in part by a grant from the Norfolk Area Sports Council

Cornhusker Auto, David & Joy Krietemeyer, Angie Eggerling, Hidden Acres Terriers, Sweet Haven Terriers, Melissa Young, Doreen Spires; Stephen & September Martin, Bryan Schramer

## Donated Perpetual Trophies:

Champion Working Terrier – Karen McCarthy, Sow's Ear Farm & Barrie Wade  
Best Open Terrier – Barrie Wade  
Best Family – Podliska Family, Hidden Acres & Mid-America Working Terriers Ass.  
Champion Puppy – Pampered Paws- Carla Morris & Hidden Acres JRT  
4 up to 6 MO. Puppy Champion – Angela Eggerling  
Under Adult Racing Champion – in Memory of Jumpin Dog Riccochet ~Bryan Schramer  
Over Adult Racing Champion – in Memory of Thornhills Doobie ~Doreen & Howard Spires

## Hotels

*New Victorian Inn & Norfolk Country Inn allows dogs in the rooms, but the dogs must be crated. Tell them you're with the Mid-America Terrier Trial. Book your rooms early. Rooms blocked until May 1, 2017 Kids less than 18 stay free at all of the hotels*

### New Victorian Inn

1001 W. Omaha Ave  
Norfolk, NE 68701  
402-379-3035  
¾ mile from trial grounds  
Call for pricing

**/dogs must be crated while in the rooms at all Times.** Breakfast & indoor pool

**Special NOTE: They will only hold the block until May 1<sup>st</sup> 2017. Please make your reservations early. Busy weekend!**

### Norfolk Country Inn

1201 S 13<sup>th</sup> St  
Norfolk, NE 68701  
1-402-371-4430  
¾ mile from trial grounds  
Call for pricing

**/Dogs must be crated while in the rooms at all times.**

Free Hot breakfast buffet in the morning or \$2 off a made to order breakfast in the restaurant  
Outdoor swimming pool.

### RV Parking-Ta-Ha Zouka Park

First come \$18.00 hookup fees  
**Please clean up after your dogs.**

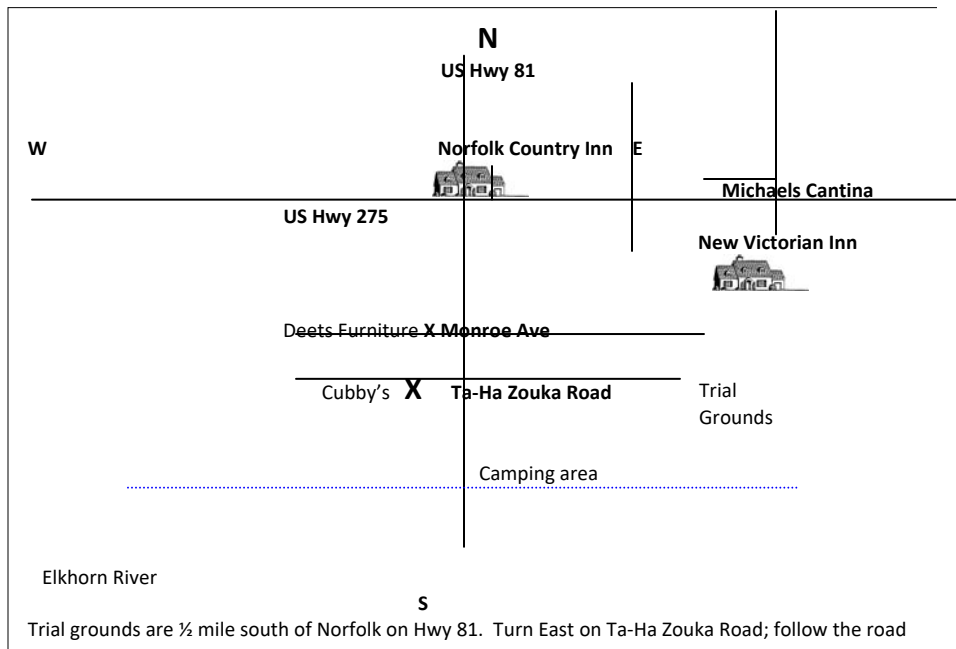

**Dogs must be crated while in the hotel room at all times, no exceptions! The hotel reserves the right to charge your credit card for any damages your dogs may do to your room. No grooming in Rooms, use Bellie bands and panties on your girls and bark collars if need be.**

**FYI:** Please keep your dogs in crates while they are in the hotel room at **all** times. We have had some instances in the past where there was damage to the rooms.



Mid-America Working Terrier Association  
Membership/ Renewal application

The Mid-America Working Terrier Association is a JRTCA Affiliate club in the Midwest. Established in 2004. Our goal is to educate and bring together the many Jack Russell Terriers & Colored Terrier owners in our area. Please plan to attend the fun days and sanctioned trials to be held throughout the year. Be prepared to have more fun than you will ever know with your dog(s)!

Name \_\_\_\_\_

Address \_\_\_\_\_

City \_\_\_\_\_

State \_\_\_\_\_ Zip \_\_\_\_\_

Telephone: \_\_\_\_\_

Email: \_\_\_\_\_

(To be used for club and Rescue information only)

Membership: (\$15.00) \_\_\_\_\_

All memberships must be renewed annually by January 1st of the New Year. Applications for new memberships received during the last three months of the year, October through December will automatically be renewed for the following year.

Signed \_\_\_\_\_ Date \_\_\_\_\_

Please sign and send application and check made out to Patti Podliska

Mail to: MAWTA

C/O: Patti Podliska  
83610 US Hwy 81  
Norfolk, NE 68701  
402-371-4699

Persons applying for membership and the members of their immediate families must not be a member of a conflicting Jack Russell Terrier Organization as defined by the JRTCA and

---

## JRT Rescue

<http://www.petfinder.com/shelters/NE35.html>

P.O. Box 540395  
Omaha, NE 68154  
Phone: 402.963.9722  
Email: [flyingjrt@aol.com](mailto:flyingjrt@aol.com)

Location of facility to view some of my dogs: Town and Country No Kill Shelter at 14110 South 84th Street, Papillion, NE 68046.

### Adopting a friend

Terriers are only placed in approved homes. We require anyone interested in adopting to complete an adoption application. We match potential homes with terriers based on the information in the application and with what we have learned about the dog. We may ask for a home visit or, if that is not possible, a photograph or video of the dog's prospective home. Rescue is a volunteer organization and relies upon donations and adoption fees in order to continue our efforts. We ask new owners for an adoption fee to cover veterinary costs, foster care expenses and any fees paid to shelters upon rescue. Adoption fees are \$150.00 for dogs over 1 years of age and \$175.00 for dogs under 1 years of age. New owners must sign a contract that states the dog will be returned to the rescue if it does not work out for any reason.

---

### Mission statement:

We specialize in search and rescue of lost/missing/stolen pets. We rehabilitate, socialize and train animals and find them forever homes ❤️

### Ways to donate:

paypal: [www.furbabyrescuemidwest@gmail.com](mailto:www.furbabyrescuemidwest@gmail.com)

Or send donations directly to:

**Furbaby Rescue**  
**PO Box 131**  
**Norfolk, NE 68702**



If someone would like to donate items such as old blankets, towels or food, etc — they can contact Furbaby Rescue for delivery @ 402-841-2366

**The Jack Russell Terrier Club of America, Inc.**

P.O. Box 4527 • Lutherville, MD 21094 • Phone (401) 561-3655 • FAX (401) 560-2563

**APPLICATION FOR MEMBERSHIP**

*Adult members must be 18 year of age; youth Members must be 10 years up to 18 years. Individual youth memberships offer limited club Privileges, including True Grit subscription, Eligibility for terrier registration and certificates; No voting privileges. A Family Youth Membership does not include True Grit*

*All memberships run yearly from January 1 to December 31 with membership fees due each year. Applications for new memberships received during the last two months of the year (November through December) will Automatically be carried over to the following calendar year.*

**Dues:**

- \$50.00 Single Adult
- \$55.00 Family (2 adults, same address)
- \$25.00 Youth (10 up to 18 year)  
Date of Birth: \_\_\_\_\_
- \$15.00 Family Youth (10 up to 18 years)  
(resident with adult member)  
Date of Birth: \_\_\_\_\_
- Outside U.S. add \$15 –  
Payment must be in U.S. dollars**

**IMPORTANT: APPLICATION MUST BE SIGNED TO BE PROCESSED**

**PLEASE TYPE OR PRINT CLEARLY**

Name: \_\_\_\_\_

If youth member, Age of Youth: \_\_\_\_\_ (10 up to 18 years only)

Street: \_\_\_\_\_

City: \_\_\_\_\_ State: \_\_\_\_\_ Zip: \_\_\_\_\_

Telephone number: A/C: \_\_\_\_\_ - \_\_\_\_\_ Fax #: \_\_\_\_\_

Have you been a member previously? Yes  No

Address Change: Yes  No  How many dogs do you own? \_\_\_\_\_

Are you a breeder: Yes  No  Number of minor children: \_\_\_\_\_

Do you belong to any other Jack Russell Terrier organizations? Yes  No

If yes, which one(s)? \_\_\_\_\_

Would you like an application to register your kennel name? Yes  No

PLEASE ENCLOSE A CHECK OR MONEY ORDER WITH SIGNED MEMBERSHIP APPLICATION OR COMPLETE THE CREDIT CARD INFORMATION BELOW.

Please charge to my: MasterCard  Visa  Expiration Date: \_\_\_\_\_

Credit Card # \_\_\_\_\_

Name on Card: \_\_\_\_\_

**DON'T FORGET TO SIGN APPLICATION!**

Persons applying for membership in the JRTCA, or renewing a current membership, must not be a Member of a conflicting JRT organization as defined by they JRTCA, and must not register their JRT's with any conflicting organization or any all-breed kennel club. Conflicting organizations accordance with the Bylaws, and regulation of the JRTCA, membership may be terminated, considered likely to prejudice or damage the image of or interfere with the efficient running of the Club, or compromise the breed in any way.

I hereby apply for membership in the JRTCA as indicated above. I agree to abide by the objectives and purpose stated in the JRTCA Constitution and Bylaws, JRTCA rules and operational policies, and the JRTCA Breeders Code of Ethics. I certify that I do not belong to a conflicting JRT organization nor do I register my Jack Russell terriers with any all-breed kennel club or conflicting registry. Furthermore, by my signature on this application, I hereby agree that all terms of the Membership Application and any disputes which may arise by and between the JRTCA and me shall be construed and enforced in accordance with, and the right of the parties shall be governed by, the laws of the State of Maryland, as if all parties have signed in the state of Maryland. Furthermore, I consent to the jurisdiction of, and agree that the sole venue which is proper for the resolution of any and all disputes between the JRTCA and me is the Circuit Court of Baltimore County in the Sate of Maryland.

**APPLICATION MUST BE SIGNED; IF JOINT OR FMAILY MEMBERSHIP, BUST INCLUDE SIGNATURES OF BOTH ADULTS. If there is only one adult in the household, please write 'ONE ADULT ONLY' on the second signature line if joining as a family with minors:**

\_\_\_\_\_ **Date:** \_\_\_\_\_

\_\_\_\_\_ **Date:** \_\_\_\_\_

**\*\*\* Note: Membership Fees are Non-Refundable. \*\*\***

**IMPORTANT**

The JRTCA is adamantly opposed to recognition/registration of the Jack Russell Terrier by ANY all-breed kennel club, as it is believed to be detrimental to the preservation of the working Jack Russell Terrier. In keeping with this policy, JRTC membership is limited to individuals who support the JRTCA's principles. Registration of the

Jack Russell Terrier (or any variant thereof) with any all-breed kennel club, or membership in any organization that supports all-breed kennel club recognition/registration, is not acceptable for application to membership in the JRATCA.

The Jack Russell Terrier is a unique working terrier that has remained virtually unchanged for more then 100 years because it has been preserved for work. It is an unspoiled type or strain of working terrier with unique character, working ability, great intelligence, sound physical structure, and broad structural differences with in the standard. These characteristics must be maintained to preserve this terrier as it remains today. The JRTCA's unique registry, with its strict inbreeding limitations and health requirements, breed standard, Breeders' Code of Ethics, and working certificate, sanctioned judge and field trial programs are all designed to do just that. All those who support the JRTCA's principles are welcome and encouraged to join the JRTCA and help us preserve this great little terrier.